

PIN GRID ARRAY SOCKETS

.100 GRID FOOT PRINT PATTERN

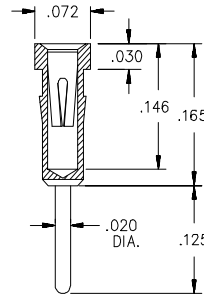

PIN STYLE 0011J
FOR PGA'S WITH PIN
COUNTS UPTO 145

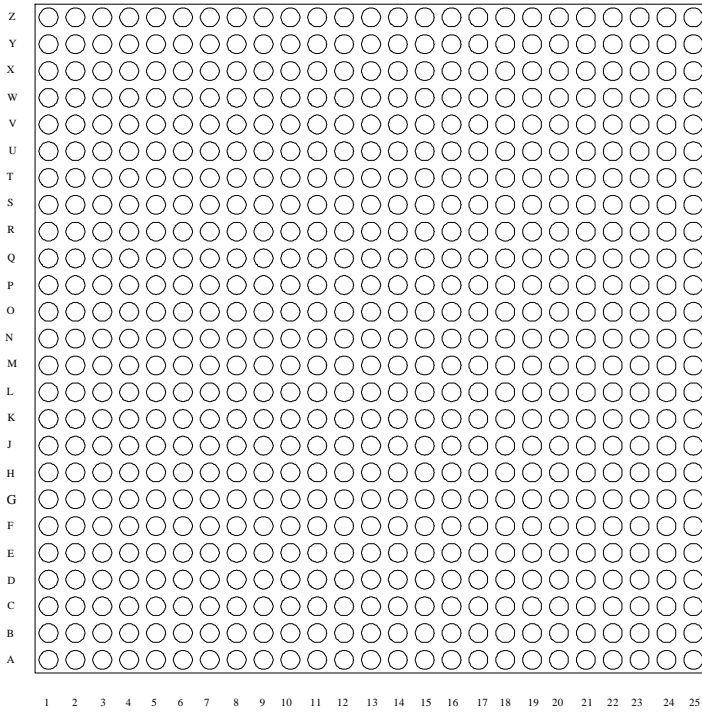
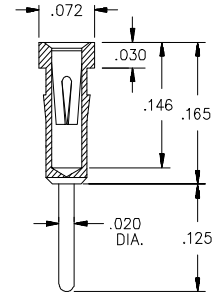

PIN STYLE 0011L
FOR PGA'S WITH PIN
COUNTS OVER 400

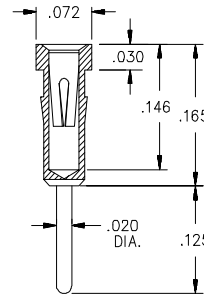

PIN STYLE 0011K
FOR PGA'S WITH PIN
COUNTS OVER 145

PIN PLATING DESIGNATIONS
 010 = TIN SHELL / 10u" GOLD CLIP
 030 = TIN SHELL / 30u" GOLD CLIP
 110 = 10u" GOLD SHELL / 10u" GOLD CLIP
 130 = 10u" GOLD SHELL / 30u" GOLD CLIP

Hi-Temp alternatives available for IR and Vapor phase soldering

144 - X - XX - 15 XX - 0011X - 010

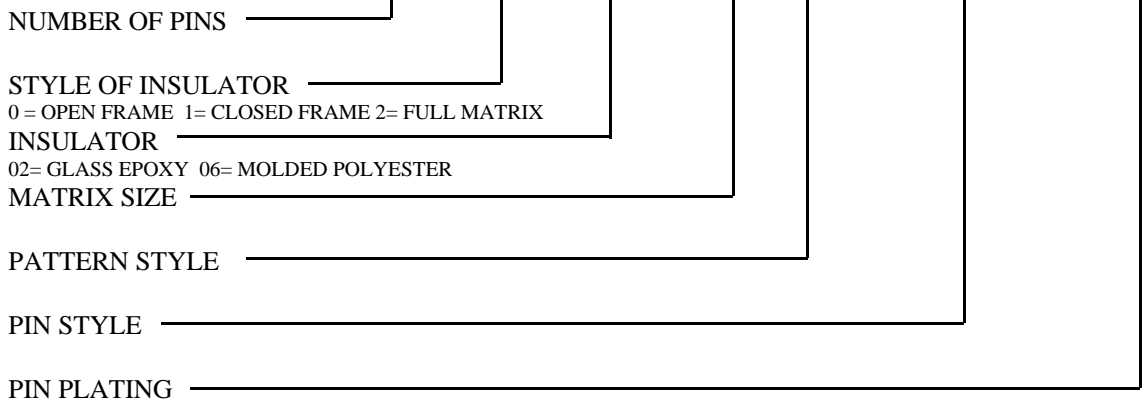

See page 24 for design guide work sheet